

2 3/8" O.D. x .154 WALL TB.

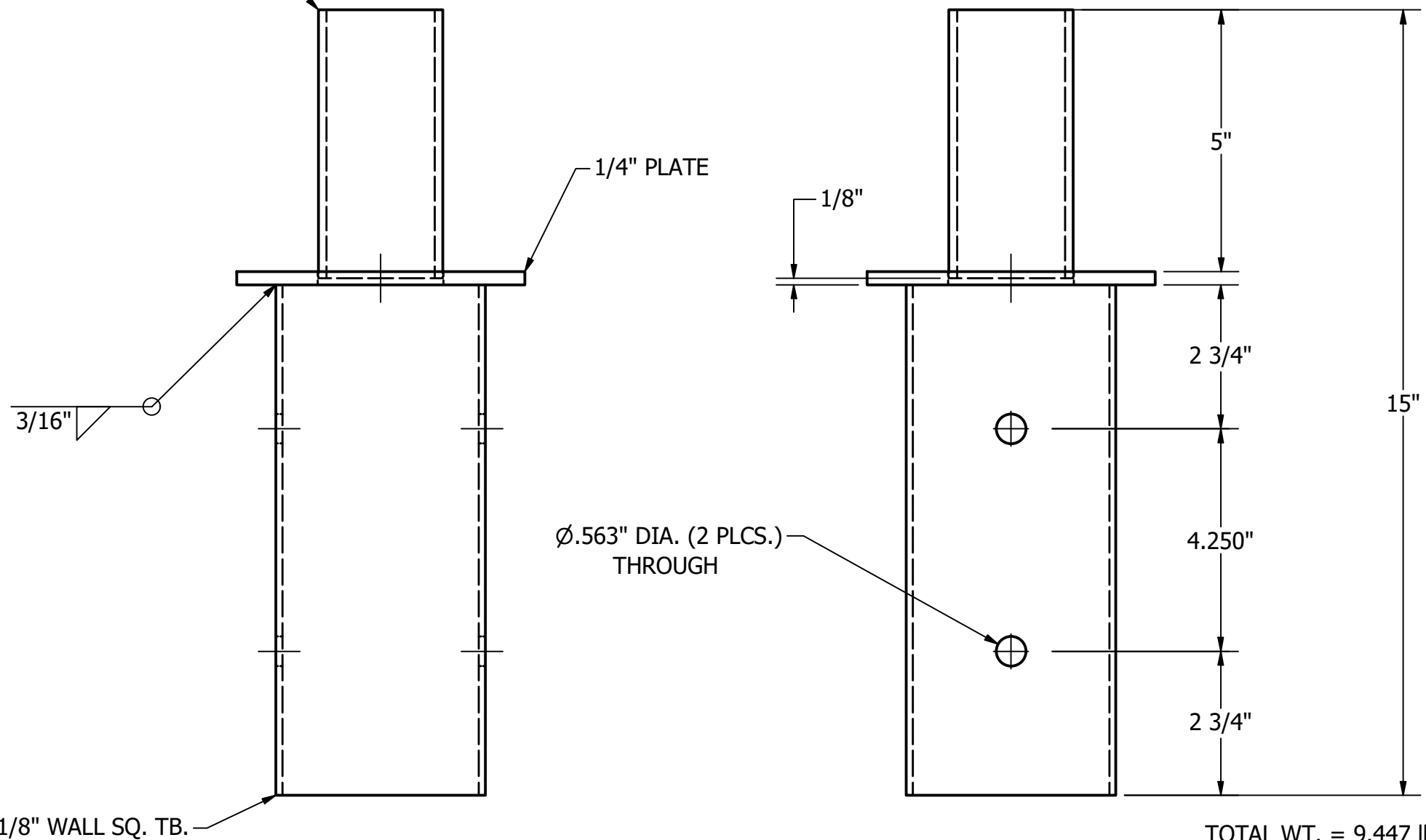
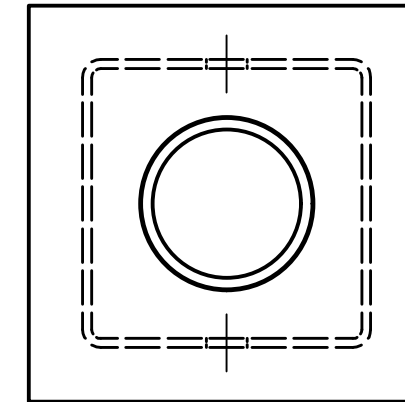

1/4" PLATE

3/16"

1/8"

5"

2 3/4"

15"

4.250"

2 3/4"

Ø.563" DIA. (2 PLCS.) THROUGH

4" x 4" x 1/8" WALL SQ. TB.

TOTAL WT. = 9.447 lbmass

| | | | | | | | | | |
|------------|-------------|-----------|--|--|-------------------------------|---|-------------------|-----------------------------------|-----------|
| | | | THIS DOCUMENT CONTAINS PROPRIETARY INFORMATION. DUPLICATION OR DISCLOSURE IS PROHIBITED WITHOUT THE EXPRESSED WRITTEN CONSENT OF FABRICATED METALS LLC | TOLERANCES: UNLESS OTHERWISE SPECIFIED FRACTIONAL ±1/8" 2 PLACE DEC. ±.03 3 PLACE DEC. ±.005 ANGULAR ± 1° | DRAWN BY: P. DAUGHERTY | UTILITY METALS (A DIVISION OF FABRICATED METALS LLC.) | PART NO. RTASQ5-2 | | |
| | | | | | APPROVED: PD | | BKT000022 | | |
| | | | | | ECN: | | DESCRIPTION: | DWG NO. | REV |
| 01 | 10-16-18 | P.D. | | | 2.4 DIA. WAS 1 1/2" - ECR-128 | | SCALE: 1/4" = 1" | 5" SQUARE REMOVABLE TENON ADAPTER | G-8136-01 |
| REV | DATE | BY | DESCRIPTION | DATE: 3/29/2018 | | | | | |